

REVISION BLOCK		
REV	DESCRIPTION	DATE

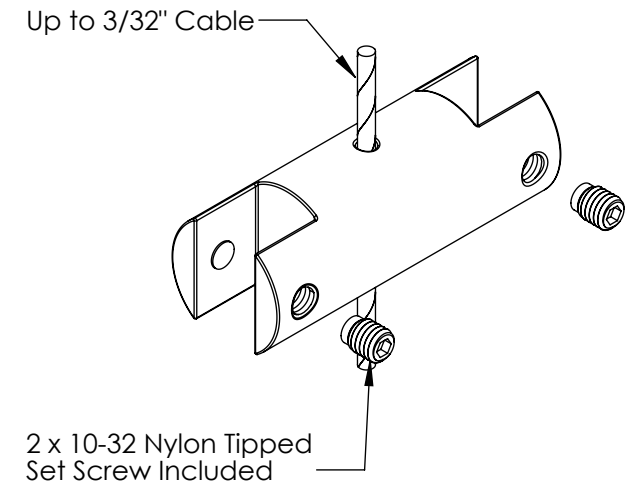
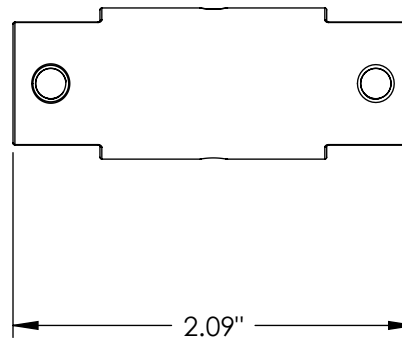
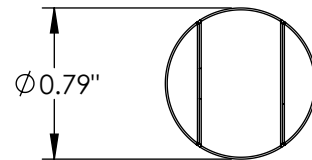
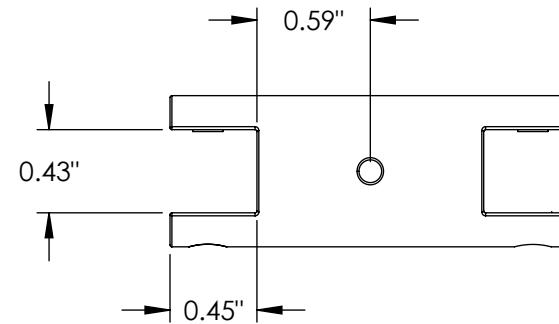

10-32 SET SCREW LENGTH	QTY.
0.23"	1
0.42"	1

Unless otherwise specified
 1. Dimensions are in inches
 2. Tolerances are:
 .XX ±.01 .XXX ±.005 Angles 1°
 3. Break all edges .005 min
 4. Finish 63 micro inches
 5. Dimensions apply after finish
 6. Concentricity = .025 TIR

DRAWN BY RDK REV INT

CHECKED BY

PROPRIETARY AND CONFIDENTIAL

This drawing and these specifications are the exclusive property of GRIPLOCK SYSTEMS INC. and shall not be divulged, reproduced, copied, or used as the basis for the manufacture or sale of apparatus without the express written authorization of GRIPLOCK SYSTEMS INC.

REF: DATE: 06/26/07

MATERIAL: SATIN CHROMIUM PLATED BRASS

SCALE: 1:1 FILE: DG-GCX2-SAT c

**GRIP
LOCK**
SYSTEMS

GRIPLOCK SYSTEMS

410 Palm Ave. Loft A18, Carpinteria, CA93013
 Phone (805) 566-0064 Fax (805) 566-0065

PART NUMBER: DG-GCX2-SAT

DESCRIPTION: Double Guide Clamp